

ANNEX # 2

ENGINEER RECONNAISSANCE REPORT

Issuing Unit: Hdqs 540th engr regt
 Place: A.P.O.#758
 Date and Hour of Issue: 190900Z sept 43

No. 2-1

Maps: Italy 1/50,000, sheets 197I, 198III, 198IV.

1. following is explanatory legend for accompanying overlay:

- (1)-H30 Ponton bridge.
- (2)-wooded Area, hard standing, bivouac for approx one (1) re giment.
- (3)-New road, dirt, two (2) way traffic, through open field.
- (4)-One (1) way bridge, concrete, thirty (30) feet long, H10.
- (5)-Two (2) way dirt road, good condition.
- (6)-swamp.
- (7)-swamp.
- (8)-stone bridge, thirty (30) feet long, height above water five (5) feet, width of roadway eight (8) feet, good condition, any army load.
- (9)-sand road, two (2) way, fair.
- (10)-ration and gas dump (45th div.)
- (11)-H30 ponton bridge.
- (12)-Two (2) way, dirt road, fair.
- (13)-concrete bridge, fifty (50) feet long, five (5) span, eight (8) feet wide, height above water twelve (12) feet, good condition, any Army load.

for the commanding officer:

Edward L. Pizdale
 Capt. CE
 S-2

C O N F I D E N T I A L

HEADQUARTERS
540TH ENGINEER REGIMENT
A.P.O.#758

151915B Sept 43

No. 6-1

Subject: Engineer Road and Bridge Reconnaissance.

To : Office of The Engineer, VI Corps, A.P.O.#306.

1. Submitted herewith road and bridge reconnaissance on area indicated on accompanying overlay as requested.

2. Legend- (Refer to accompanying overlay Map Reference-Italy 1/50,000, Sheet #197 I.)

1. Small timber bridge-7 feet wide-4 feet long-bog on either side. Poor condition.
2. Concrete arch culvert-bridge-will carry any army load. Eight feet wide.
3. Same as above.
4. Same as above.
5. Two story cement house. Good but limited wooded bivouac.
6. Open field, wooded, large trees, an approximately one battalion bivouac area.
7. Concrete bridge-one span-sixty feet long-eight feet wide-fair to poor condition-estimated fifteen ton-canal graded on each side-fill 10 feet high.
 - A. Narrow one way road at B bog-impassable-is by-passed thru field for about fifty yards.
 - C. One way trail to beach can be two way because of lack of shoulders, sand.
 - D. Hard dirt and gravel road two way in good condition.
 - E. Fair, two way, dirt road.
8. Concrete, crown type, crown two feet at center, ninety five feet length of bridge, center span twenty five feet, clear width 10 feet. One way. Three span. H-30.
9. Bridge concrete, length 50 feet, width 18 feet, height above water 8 feet. Four 10" by 16" concrete stringers. Actual span 25 feet. H-30
10. Concrete bridge, length of span 30 feet, 12 feet above water, 10 feet wide, deck 8", three ten by twenty inch concrete stringers, bank to bank 60 feet. H-20.
11. Concrete bridge, length of span 35 feet, height above water ten feet width 18 feet, concrete deck 10", four ten inch by twentyfour inch concrete stringers, bankseat to bankseat 60 feet, H-30.

For the Commanding Officer:

Edward L. Fildale
Capt, CE.
S-2

DECLASSIFIED

Authority 73507

BPA NARA Date 12/2/95

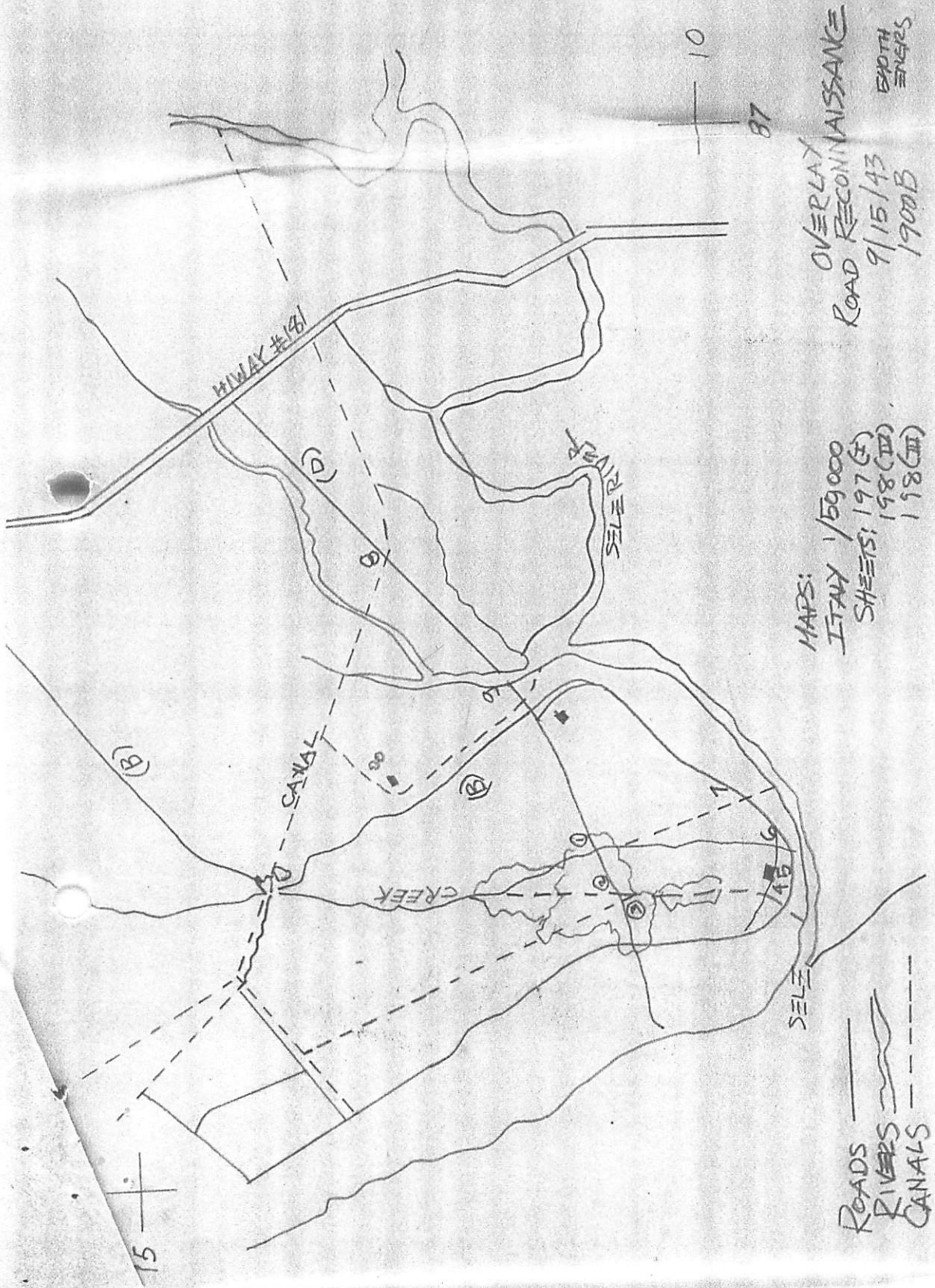

OVERLAY
ROAD RECONNAISSANCE
9/15/43
1900B
BATH
ENGRS

MAPS:
ITALY 1/59000
SHEETS: 197 (F)
198 (III)
198 (III)

ROADS
RIVERS
CANALS

ANNEX #4

C O N F I D E N T I A L

HEADQUARTERS
540TH ENGINEER REGIMENT
A.P.O. #464

Date and Hour of Issue:
201530B Sept 43

ENGINEER RECONNAISSANCE REPORT
BEACH SURVEY

Maps: Italy, 1/50,000, Sheet #198 III.
No. 7-1

BEACH SOUTH
(AGROPOLI)

Location of center: 40 214 40" N, 2 31' 40" E.
Coordinated: S847964 to S84599563.
Length: 1,000 yards.
Width: 30 yards.

WATER: Seaward approach clear. Water appears fairly deep just off-shore. Protected from southwest winds by neck of land jutting seaward just north of AGROPOLI. (NOTE: This reconnaissance made by army personnel and would have to be amplified and confirmed by navy personnel.)

BEACH: Sandy beach mixed with gravel. Slopes gently from water's edge to secondary road paralleling water. Southern end of beach near mouth of River Teste is marshy and sand ledge rises approximately two feet above water. Beach is not mined and contains no wire.

EXITS: Paths suitable for vehicle exit running from beach to parallel road are located at S847961, S846958, and S845957. Secondary road which leaves Highway #18 at S871986 runs S.W. to beach line after which it follows water line to S845953. Through which stretch it is an average of only one hundred yards from water. This road in it's stretch paralleling Beach South is on a five feet fill. Inland of beach the land rises sharply to a height of two hundred and twenty metres one mile from the beach.

DUMPS: Nearest possible dump area is region bounded by Selefrone River on N., Highway #18 on E., sea on the W., and above described secondary road on S., at a distance of approximately one and three quarters miles from the beach.

ENGINEER TASKS: Dozer improvement of exits (one half hour work by D-7); construction of short section of beach roadway (four rolls of Sommerfeldt Matting per exit); erection of beach markers.

RECOMMENDATION: Harbor of AGROPOLI is absolutely unfit for unloading of any type. It is completely enclosed by sheer cliff and inaccessible except for a narrow footpath. At water's edge is rock outcropping and almost no beach. There is one mole one hundred and fifty yards long and ten yards wide surrounded by rocks and unsuitable for unloading. BEACH SOUTH described above is only beach found between SOUTH BLUE and AGROPOLI suitable for beach unloading pending confirmation by Navy.

For the Commanding Officer:

Edward L. Fizdale
Capt, CE.
S-2

C O N F I D E N T I A L

ANNEX #5

ENGINEER RECONNAISSANCE REPORT NO. 8-1
(STAGING AREA)

Issuing Unit: Hqs 540th Engr Regt
 Place: A.P.O. #464
 Date and Hour of Issue: 41900A sept 43

Maps: Italy 1/25,000, sheets #184 III NE, 184 IV SE.
 (Refer to attached overlay)

1. SURVEY OF SPECIFIED STAGING AREA.

a. Description of Bivouac Areas and road Network.

- (1) Generally good bituminous roadway, two way. Except for section described in (2) below.
- (2) As indicated on overlay combination bridge and overpass demolished. On lower highway debris and fallen power lines obstruct road and keep traffic to one way at present. Approximately two (2) hours bull dozing will clear this. At present vehicles with trailed load will not pass.
- (3) Overpass partially destroyed. debris on lower road limits to one way traffic. Can be easily cleared.
- (4) Large cistern obstructing road must be cleared to pass traffic.
- (5) fairly good bivouac area. Accessible in valley. some concealment. Estimated capacity two (2) regiments.
- (6) Park with mineral springs for water supply. several available building adequate for one (1) company.
- (7) Bivouac area in race track. Ten large buildings, two (2) grandstands, good drainage, grassy, wooded, twenty (20) small buildings. Estimated capacity four thousand (4,000) troops.
- (8) Large bivouac vicinity Bagnolia railhead. several large buildings. Germans had magazines here which have been blown. should accomodate 5,000 troops.
- (9) Large flat field near refinery. Probably bad drainage in case of rain. Estimated capacity 2,000 troops.
- (10) football field in Bagnoli capacity one regiment.
- (11) generally demolished industrial area unsuitable.
- (12) generally unsuitable mountainous area.

Edward L. Fisdale
 Capt. CE
 8-2

DECLASSIFIED

Authority 73507
BPO NARA Date 12/2/45

Reproduced at the National Archives

C O N F I D E N T I A L

HEADQUARTERS
540TH ENGINEER REGIMENT
A.P.O.#464

Date and hour of issue: 180900g sept 43

ENEMY MINEFIELD REPORT

AREA Mouth of Sele River UNIT 540th Engrs CORPS VI

MAP Italy 1/50,000 sheet #198 III

LANDMARK Lookout tower, 50 feet high, concrete MAP REF NO8858052

Landmark to P-1 515 yards azimuth 295°

NO. BLOCKS IN BELT 14 NO. MINES IN BLOCK 7/148, 6/144, 1/277.

NO. ROWS IN BLOCK 13 four row, 1 eight row. TOTAL NO. MINES 2200

TYPE MINES TM 2, 3, 4, and wooden box NO. BOOBYTRAPPED 65

DENSITY .9 (m/yd front) TYPE BOOBYTRAP ZZ 35, DZ 35.

DISPOSITION entire field lifted by Co. "C", 540th Engrs and mines placed in ordnance salvage dump and sunk at sea per 1000 Engr VI Corps

REMARKS Minefield easily located due to faulty camouflage of spoil on beach. Fifteen datum poles at edge of each block aided in understanding pattern. Regular pattern throughout except for block #2 which was 8 rows, one of them underwater. Details of wooden box mine included in tactical and technical information no. 4-2, above hdqs.

Edward L. Fisdale
Capt, CE
S-2

(OVER)

DECLASSIFIED

Authority 73507

BR NARA Date 12/2/45

Reproduced at the National Archives

TACTICAL + TECHNICAL NO. 1-2
S-2 RECONNAISSANCE SECTION
HDQS 540TH ENGRS
MINE FIELD SKETCH

18 sept 45

ANNEX # 6

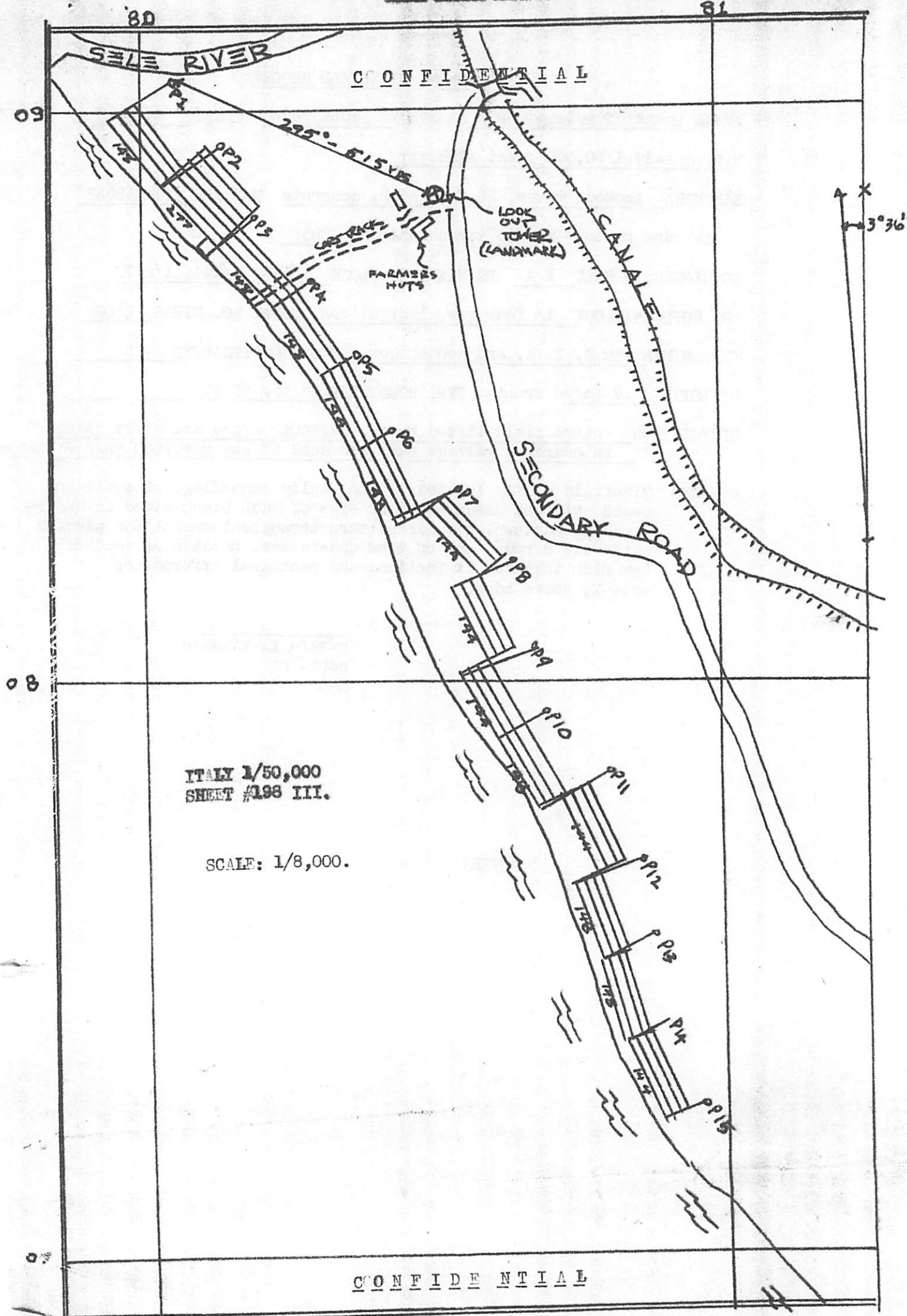

(OVER)

*ANNEX #*C O N F I D E N T I A LENGINEER RECONNAISSANCE REPORT NO. 15 8-1
(STAGING AREA)

Issuing Unit: Hqs 540th Engr Regt
 Place: A.P.O.#464
 Date and Hour of Issue: 41900A Sept 43

Maps: Italy 1/25,000, Sheets #184 III NE, 184 IV SE.
 (Refer to attached overlay)

1. SURVEY OF SPECIFIED STAGING AREA.

a. Description of Bivouac Areas and Road Network.

- (1) Generally good bituminous roadway, two way. Except for section described in (2) below.
- (2) As indicated on overlay combination bridge and overpass demolished. On lower highway debris and fallen power lines obstruct road and keep traffic to one way at present. Approximately two (2) hours bull dozing will clear this. At present vehicles with trailed load will not pass.
- (3) Overpass partially destroyed. Debris on lower road limits to one way traffic. Can be easily cleared.
- (4) Large cistern obstructing road must be cleared to pass traffic.
- (5) Fairly good bivouac area. Accessible in valley. Some concealment. Estimated capacity two (2) regiments.
- (6) Park with mineral springs for water supply. Several available buildings adequate for one (1) company.
- (7) Bivouac area in race track. Ten large buildings, two (2) grandstands, good drainage, grassy, wooded, twenty (20) small buildings. Estimated capacity four thousand (4,000) troops.
- (8) Large bivouac vicinity ~~of~~ Bagnolia Railhead. Several large buildings. Germans had magazines here which have been blown. Should accommodate 3,000 troops.
- (9) Large flat field near refinery. Probably bad drainage in case of rain. Estimated capacity 2,000 troops.
- (10) Football field in Bagnoli capacity one regiment.
- (11) Generally demolished industrial area unsuitable.
- (12) Generally unsuitable mountainous area.

Edward L. Fisdale
 Capt, CE
 S-2